

MALDIVES LAND AND SURVEY AUTHORITY**MINISTRY OF HOUSING AND INFRASTRUCTURE**

Office (PABX): +(960) 3004300, Fax: +(960) 3004254

Email: survey@housing.gov.mv

Web: www.surveyofmaldives.gov.mv

Ameenee Magu, Maafannu, Male', 20392, Maldives

**CONTROL POINT DETAILS**

Station Number: PSM5462

Coordinate Information

Geodetic

Grid

WGS 84

UTMNorth-Zone_43 : 72E to 78E

Lat: 4°12'48.53820"N

E: 332003.691m

Long: 73°29'10.93466"E

N: 465887.942m

Ellp Height: -93.494m

Orth Height: +1.386 m from MSL

Island Name: K.Feydhoofinolhu

Date: 21 November 2016

Monument description & method of survey:

- Fixed to "type A monument" specifications.
- Horizontal Control
 - High accuracy static data continuously observed for 4hrs with Topcon GR-5 receiver.
 - Post processed and network analyzed.
 - Main control for both vertical and horizontal
- Vertical Control
 - Tide reading related to MMD Tide Table for Hulhule region.
 - Level reduced to MSL.

General site condition & access:

- PSM5462 is established on the Eastern side the island.

Owner: Pearl Atoll. Pvt. Ltd.

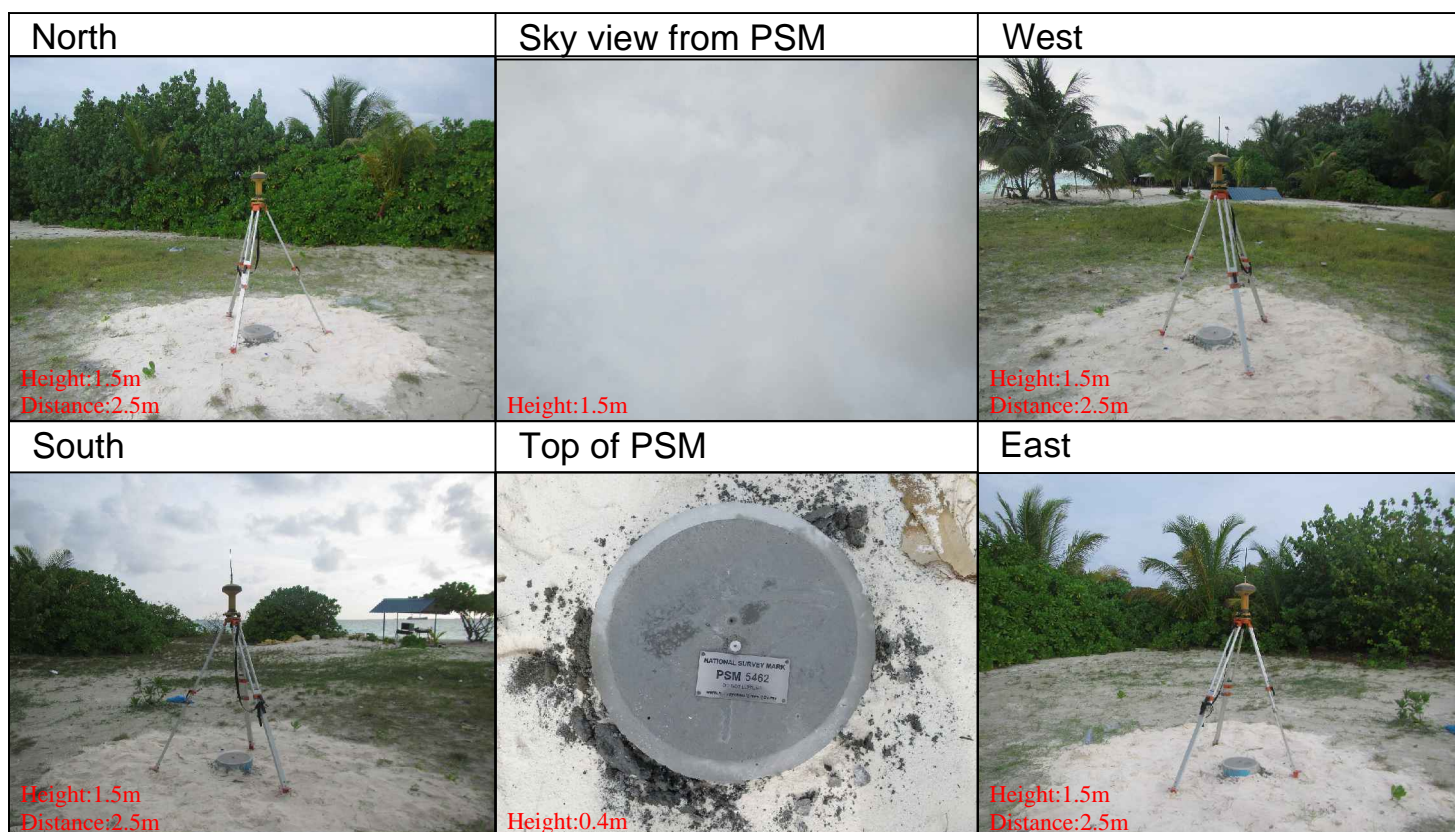

SITE INFORMATION

Station Number

P	S	M	5	4	6	2
---	---	---	---	---	---	---

Station Horizon Mask

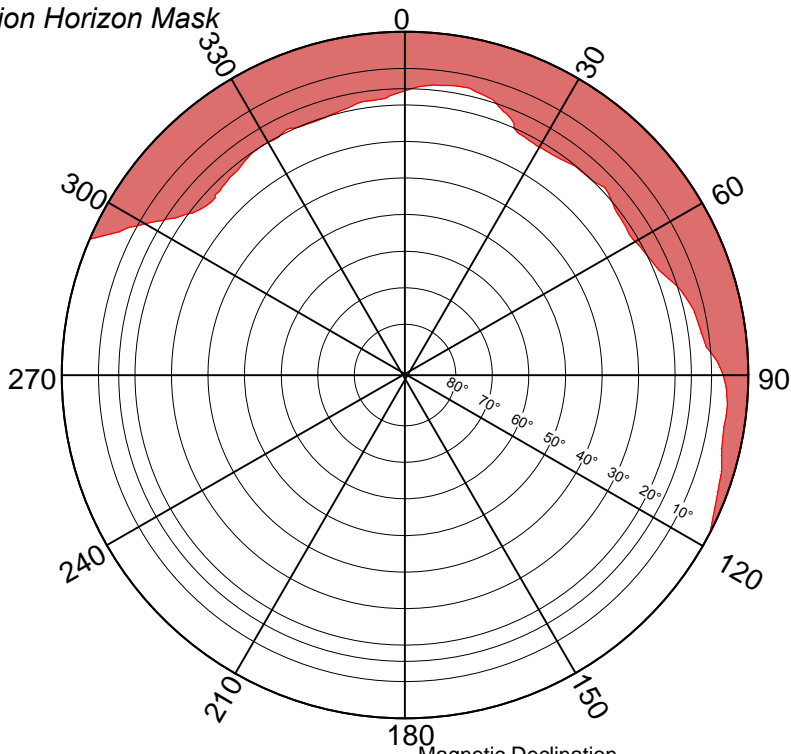

Height above Marker horizon was mapped from 1.500m

Magnetic Declination.....
 Declination applied to this figure?
 Yes No

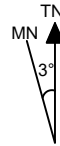

Locality

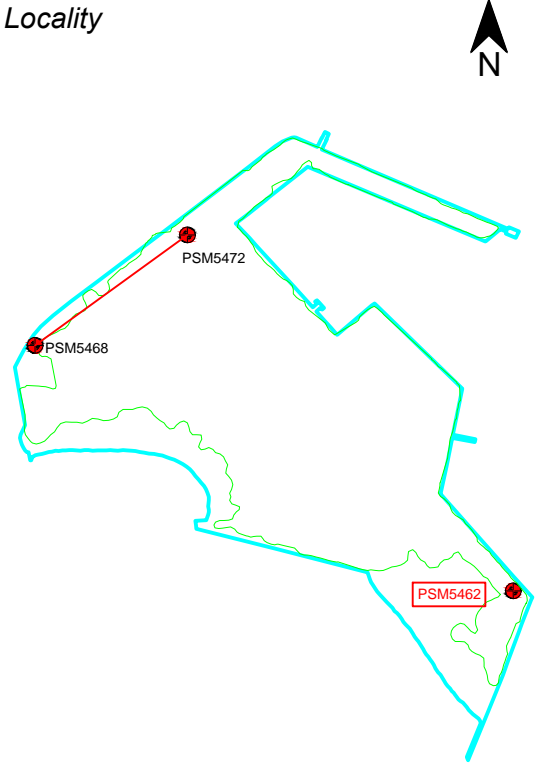

Coconut Palm

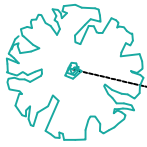

$284^{\circ}43'33''$
12.197m

Coconut Palm

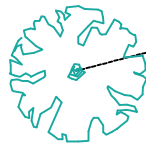

$256^{\circ}31'03''$
7.526m

PSM5462



Sketched by: Ibrahim Mizal Mohamed

Scale: Not to scale

Date: 21 Nov 2016

MALDIVES LAND AND SURVEY AUTHORITY

MINISTRY OF HOUSING AND INFRASTRUCTURE

Office (PABX): +(960) 3004300, Fax: +(960) 3004254

Email: survey@housing.gov.mv

Web: www.surveyofmaldives.gov.mv

Ameenee Magu, Maafannu, Male', 20392, Maldives



CONTROL POINT DETAILS	Station Number: PSM5468
Coordinate Information	
Geodetic	Grid
WGS 84	UTMNorth-Zone_43 : 72E to 78E
Lat: 4°12'53.12042"N	E: 331748.516m
Long: 73°29'02.65093"E	N: 466029.182m
Ellp Height: -93.664	Orth Height: +1.208m from MSL
Island Name: K.Feydhoofinolhu	Date: 21 November 2016

Monument description & method of survey:

- Fixed to "type A monument" specifications.
- Horizontal Control
High accuracy static data continuously observed for 3hrs with Topcon GR-5 receiver.
Post processed and network analyzed.
- Vertical Control
level transferred from PSM5462

General site condition & access:

- PSM5468 is established on the Western side of the island.

Owner: Pearl Atoll. Pvt. Ltd.

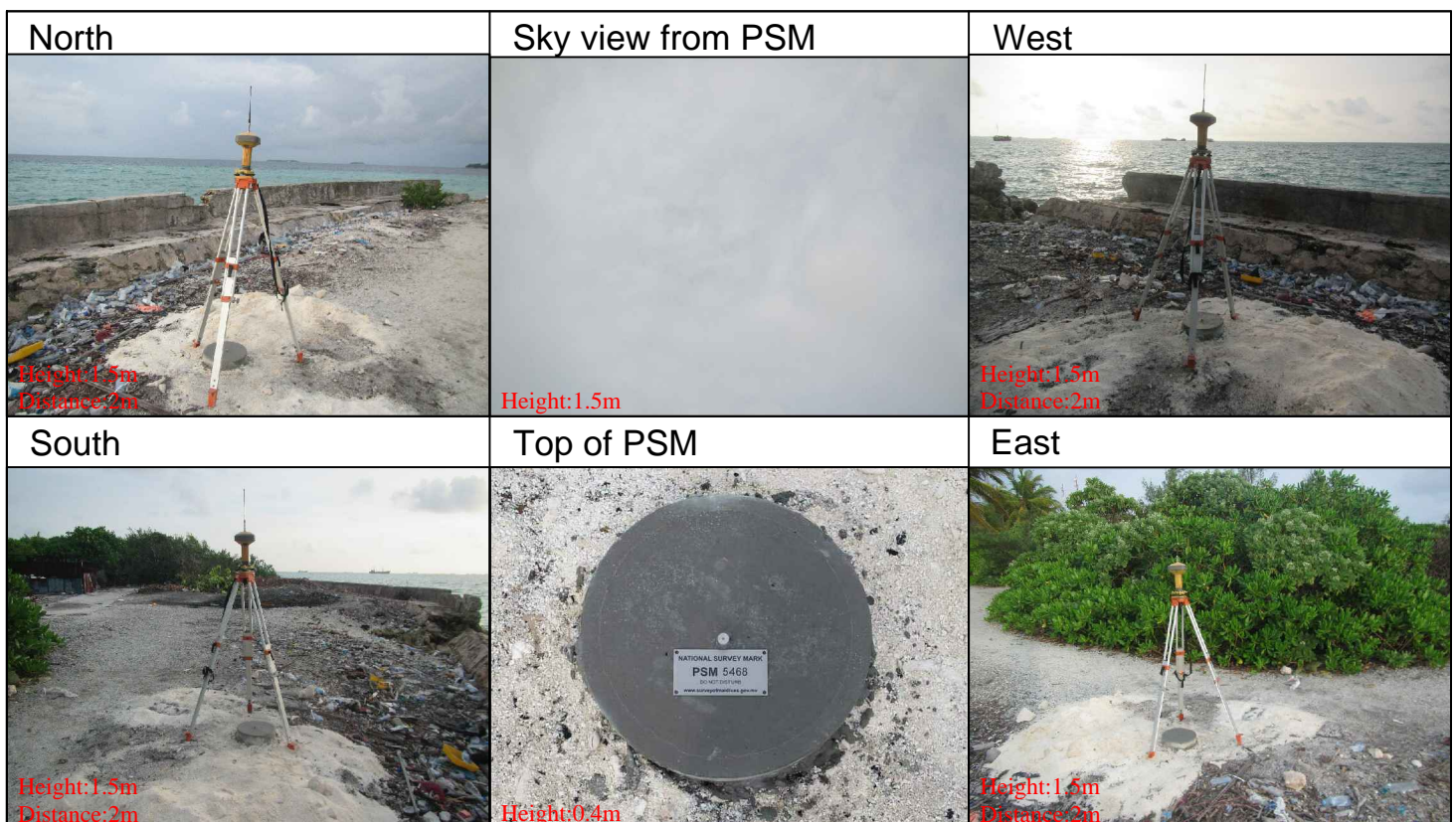

SITE INFORMATION

Station Number

P	S	M	5	4	6	8
---	---	---	---	---	---	---

Station Horizon Mask

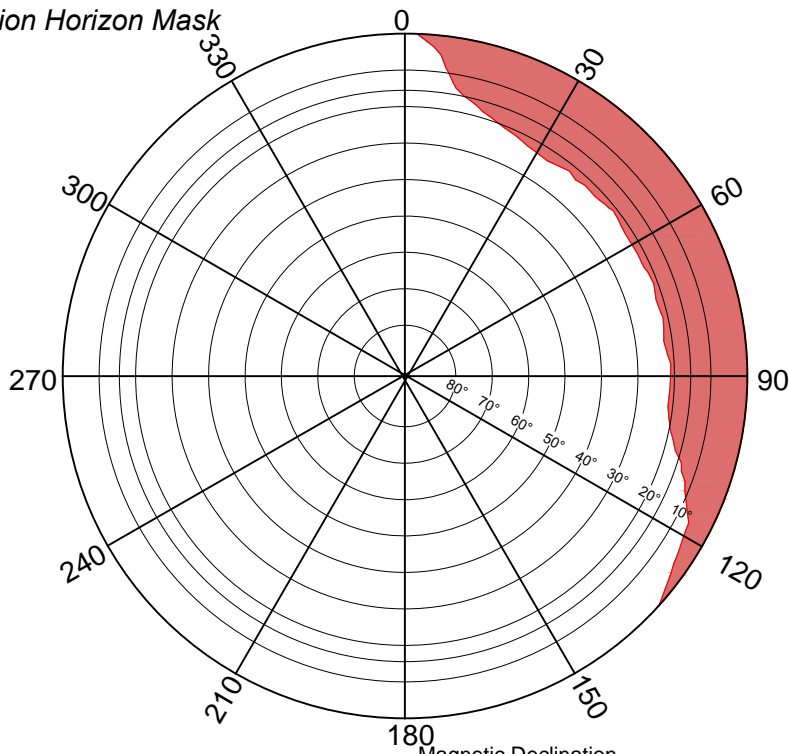

Height above Marker horizon was mapped from 1.500m

Locality

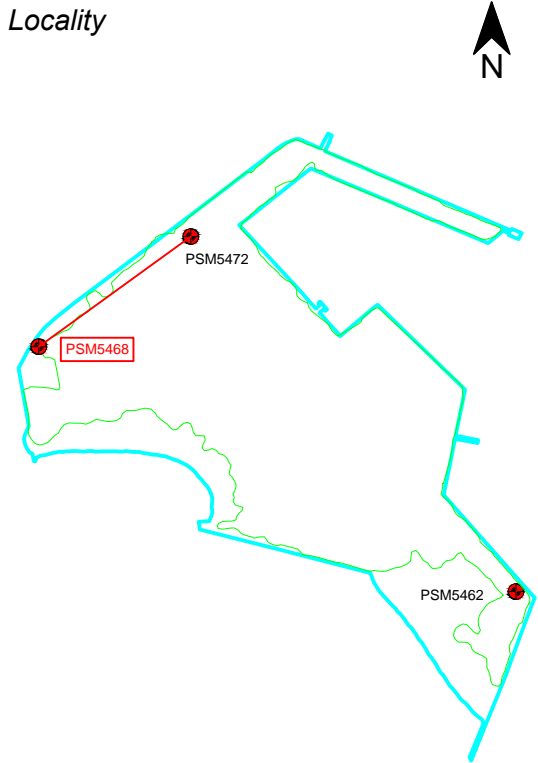

North

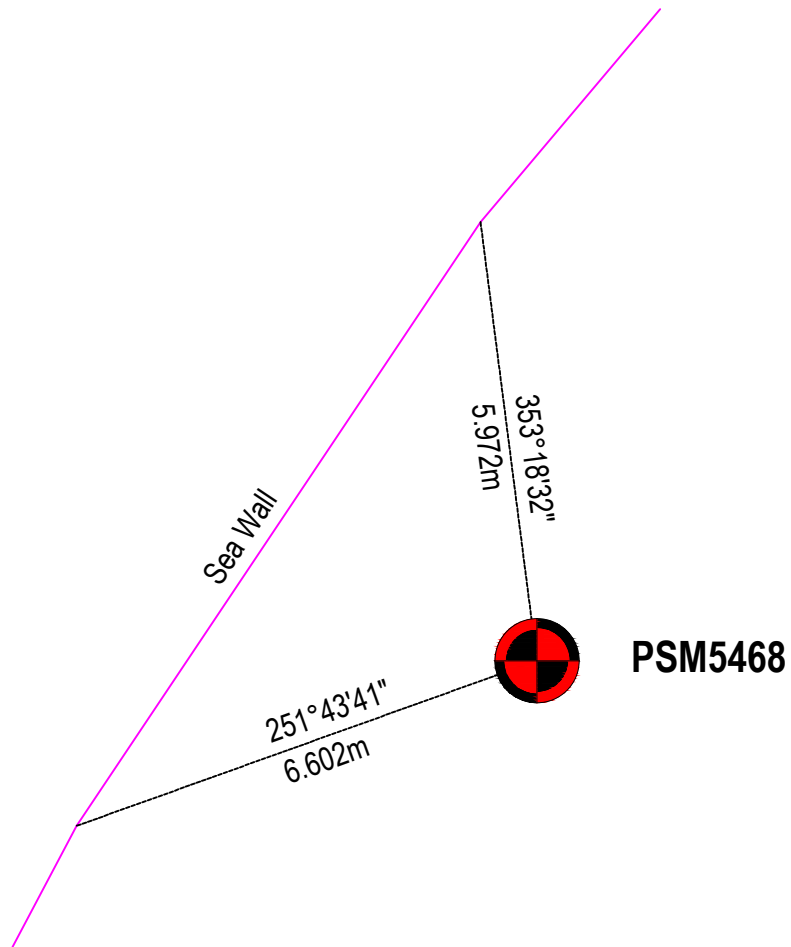

Sketched by: Ibrahim Mizal Mohamed

Scale: Not to scale

Date: 21 Nov 2016

MALDIVES LAND AND SURVEY AUTHORITY**MINISTRY OF HOUSING AND INFRASTRUCTURE**

Office (PABX): +(960) 3004300, Fax: +(960) 3004254

Email: survey@housing.gov.mvWeb: www.surveyofmaldives.gov.mv

Ameenee Magu, Maafannu, Male', 20392, Maldives



CONTROL POINT DETAILS	Station Number: PSM5472
Coordinate Information	
Geodetic	Grid
WGS 84	UTMNorth-Zone_43 : 72E to 78E
Lat: 4°12'55.19604"N	E: 331836.203m
Long: 73°29'05.49044"E	N: 466092.765m
Ellp Height: -93.785m	Orth Height: +1.078m from MSL
Island Name: K.Feydhoofinolhu	Date: 21 November 2016

Monument description & method of survey:

- Fixed to "type A monument" specifications.
- Horizontal Control
High accuracy static data continuously observed for 3hrs with Topcon GR-5 receiver.
Post processed and network analyzed.
- Vertical Control
level transferred from PSM5462.

General site condition & access:

- PSM5472 is established on the Northwestern side of the island.

Owner: Pearl Atoll. Pvt. Ltd.

North	Sky view from PSM	West
<p>Height: 1.5m Distance: 2m</p>	<p>Height: 1.5m</p>	<p>Height: 1.5m Distance: 2.5m</p>
South	Top of PSM	East
<p>Height: 1.5m Distance: 2m</p>	<p>Height: 0.4m</p>	<p>Height: 1.5m Distance: 2m</p>

SITE INFORMATION

Station Number

P	S	M	5	4	7	2
---	---	---	---	---	---	---

Station Horizon Mask

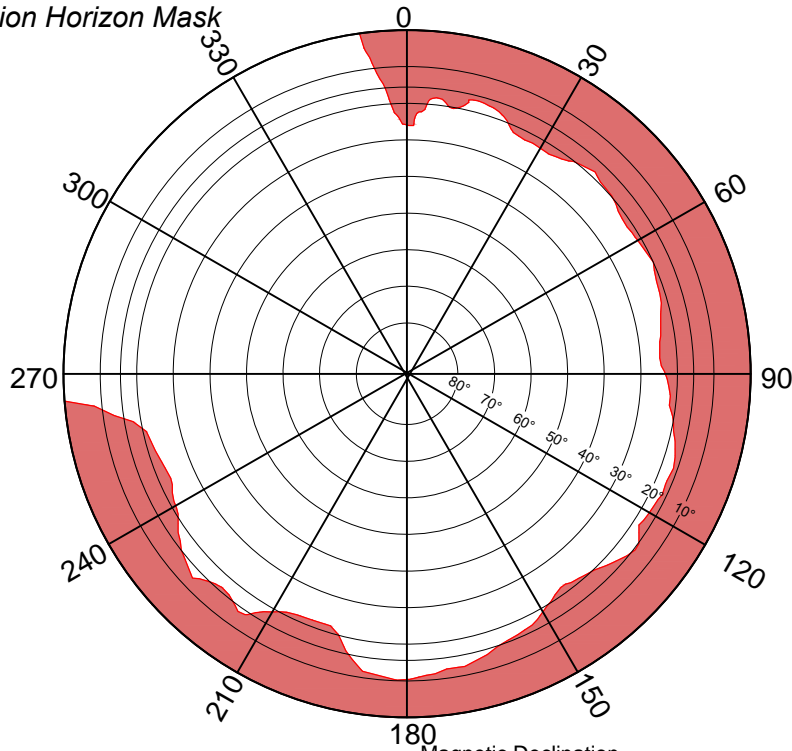

Height above Marker horizon was mapped from 1.500m

Magnetic Declination.....
 Declination applied to this figure?
 Yes No



Locality

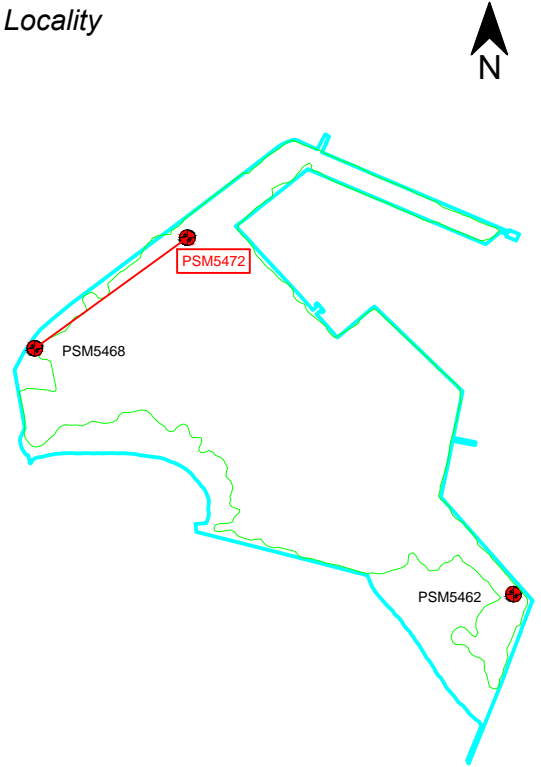

North

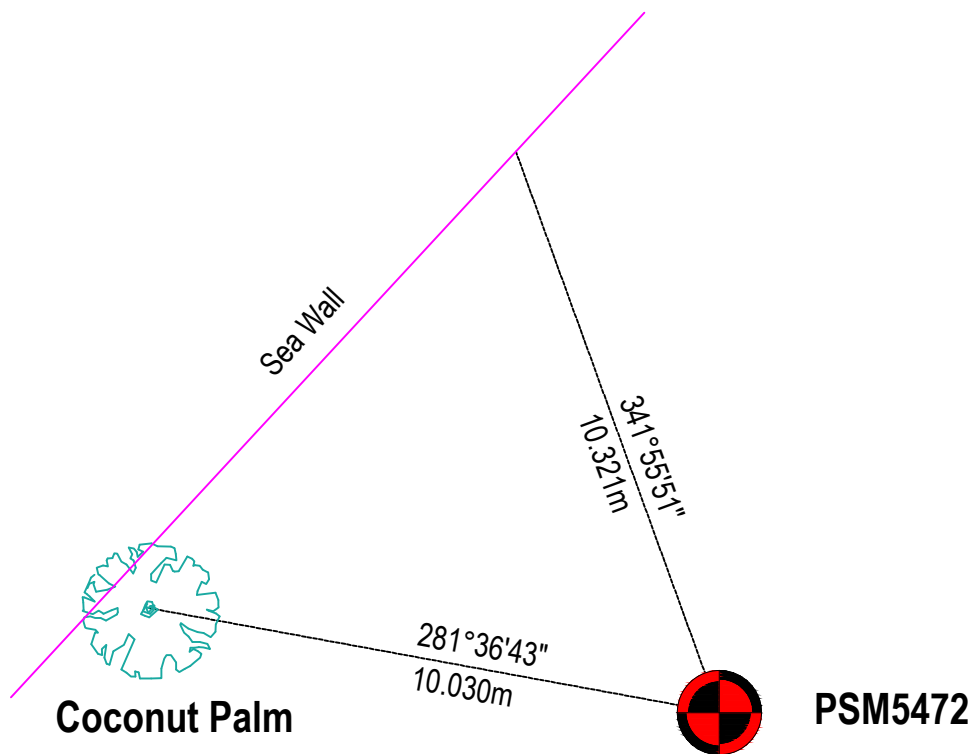

Sketched by: Ibrahim Mizal Mohamed

Scale: Not to scale

Date: 21 Nov 2016